

# Jockey Wheels

## Automotive Products

### 6" Jockey Wheel Solid Clamp Type

**#VP8700**  
 Capacity: 750lbs

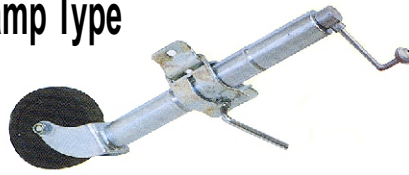

**Swing-Up 6" Solid #VP8710** Capacity: 750lbs

**Swing-Up 8" Solid #VP8720** Capacity: 500lbs

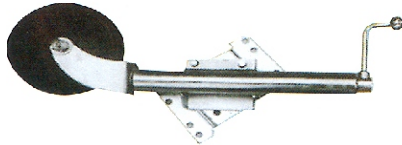

**Swing-Up 10" Pneumatic Jockey Wheel**



### Electric Winch

**#VP8520**

With Power In/Power Out

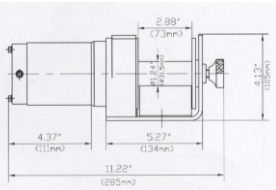

Capacity: 906kg  
 Cable length: 15m  
 Cable dia: 5.4mm  
 0.9HP at 12 Volts  
 1HP at 24 Volts

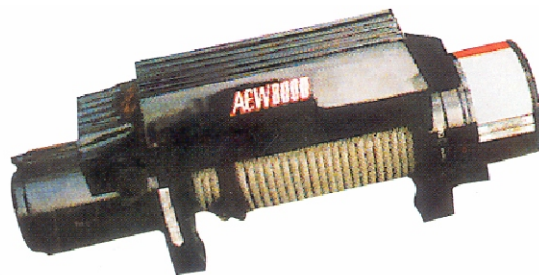

**#VP8558**

Performance: 12VDC  
 Single line rated pull: 5443kg  
 Motor: 6HP/4.5kw, series wound  
 Control remote switch on 3.7m lead  
 Cable length: 15 metres  
 Cable dia: 10mm  
 Gear train: 3 stage planetary  
 Gear reduction ratio: 265.2:1  
 Clutch: sliding ring gear  
 Braking action automatic  
 Size: 62L x 31W x 32Hcm  
 44KGS

### Portable Winch

**#VP8550**

12 Volt 2721 kg  
 Cable length: 10 metres  
 Cable dia: 5mm



### Electric Winches

**#VP8556**

Performance: 12VDC/24VDC  
 Single line rated pull: 3856kg  
 Motor: 5.5HP/4.0kw, series wound  
 Control remote switch on 3.7m lead  
 Cable length: 15 metres  
 Cable dia: 8.3mm  
 Gear train: 3 stage planetary  
 Gear reduction ratio: 235:1  
 Braking action automatic in-the-drum  
 Size: 62L x 36W x 26Hcm  
 40Kgs

**#VP8557**

Performance: 12VDC  
 Single line rated pull: 4310kg  
 Motor: 5.5HP/4.1kw, series wound  
 Control remote switch on 3.7m lead  
 Cable length: 15 metres  
 Cable dia: 9.2mm  
 Gear train: 3 stage planetary  
 Gear reduction ratio: 265.2:1  
 Clutch: sliding ring gear  
 Braking action automatic  
 Size: 62L x 36W x 26Hcm  
 40KGS

**#VP8557RC** Remote control to suit VP8557

**REFER TO PRICELIST -**

**Part Nos. In Alphabetical order**

### Hand Winch

**#VP85WH**

Cable size: 4.22mm x 8m  
 350Kg

